

The 78ft / 24m FPB motor yacht 'Grey Wolf' was built in 2017 by Circa Marine [New Zealand] and designed by Steve Dashew. It is a purpose built polar boat with a CAT 0 rating, massive cruising range, extreme weather capabilities and a high level of comfort.

SPECIFICATIONS

LENGTH

23.86 m | 78.28 ft

BEAM

6.12 m | 20.07 ft

YEAR

2017

CRUISING SPEED

10.75 knots

FLAG

BRITISH

DRAFT

1.85 m | 6.06 ft

CONSTRUCTION

ALLOY

RANGE

3800 @ 10kn

RATING

CAT 0

ACCOMMODATION

GUESTS	CABINS	CREW
--------	--------	------

6*	3	3*
----	---	----

GUEST CABIN CONFIGURATION

1 Master (Double can be split to two singles)

2 Guest (Double) + 1 Pipe Berth

* Up to 7 Guests with Pipe Berth in Port Guest

* Crew dependent on guest numbers and location



ACCOMODATION

Grey Wolfs interior layout sleeps up to 6 guests in 3 rooms, including a master suite and two double cabins. Each room has its own ensuite. For larger groups the master suite can be split into two singles and the port guest has an optional pipe berth.



Master Cabin: Spacious King Size Bed, Ample Storage, Separate Shower and Head, Full Wardrobe and Large Open Basin

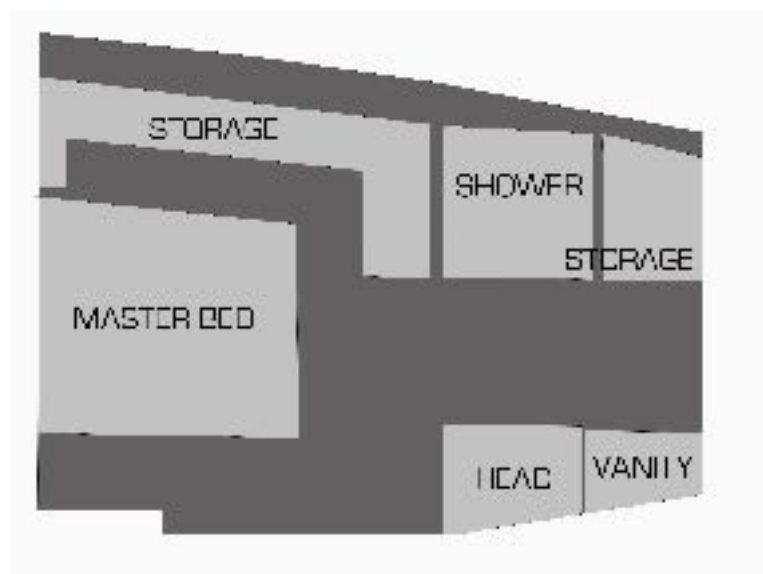



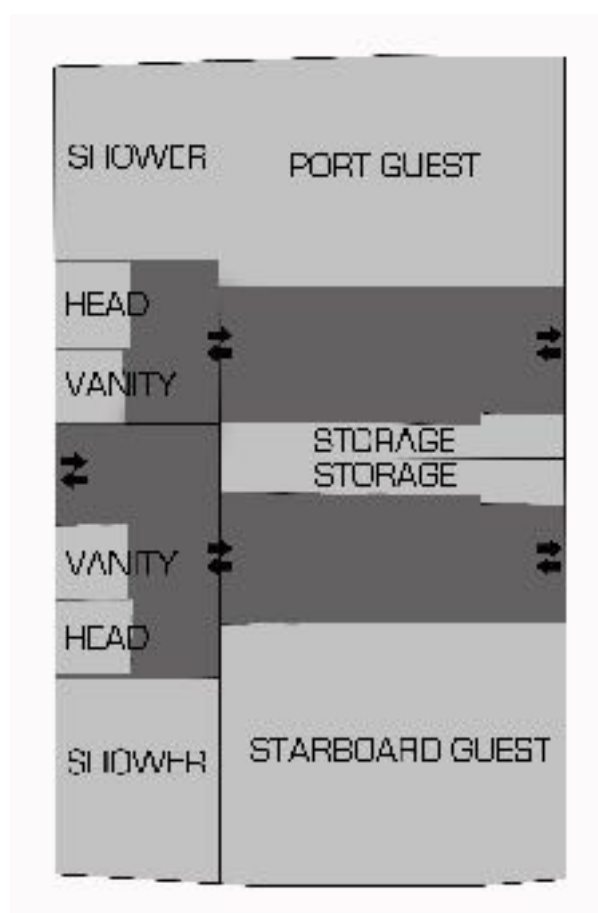

PERFORMANCE

Grey Wolf is built for form and function. The Aluminium Hull and Aluminium superstructure are built beyond spec and require almost no maintenance.

She is equipped with the NAIAD active stabilizer system to ensure comfortable cruising in all conditions. She has a massive 18360 L Fuel capacity and 7100 NM range as well as 300 L/hr water-maker.

The design also included natural ventilation, a paint-less finish and 3.4kW solar array for reduced carbon footprint. As well as extensive EPDM Insulation to ensure maximum noise suppression from the engine generator and reducing heat transfer with the environment.

Grey Wolf can be piloted via two helms, each with 3x Radar, ECDIS and Navionic Charts, KVH and Satellite Compass, FLIR camera and a Furuno 360 searchlight sonar for exceptional navigation in any weather.

Even when offshore Grey Wolf can stay connected to the world via the Iridium Pilot, Iridium Go, HF | MF Radio, Sat C and Icom A120 for aircraft communications to ensure up to date weather forecasting and safety messages.













Grey Wolf is built to comply to MCA Cat O Standards Grey Wolf is built to comply to MCA Cat O Standards Grey Wolf is built to comply to MCA Cat O Standards, which allows her to operate in international waters at any distance from a safe port. Twin 231 Hp John Deeres push her along at a cruising speed of 11 knots and a max speed of 13.25 knots. All of these features mean Grey Wolf can reach those far-away places, comfortably, safely, stylishly and efficiently without the need of timely refuelling or resupplying.

SPECIFICATIONS

Length: 23.86 m 78.28 ft	Gross Tonnage: 81.81 gt	Generation Cummins Generator
Builder: Circa Marine	Cruising Speed: 10 knots	3.4kW Solar Array
Designer: Steve Dashew	Top Speed: 13.25 knots	2x 250amp Alternators
Model: FPB 78	Engines: John Deere 6068AFM85 M1	Flag British
Built: 2017	Fuel Capacity 18360 L 4850 gallons	Port Jersey
Beam: 6.12 m 20.07 ft	Fresh Water 4160 L 1099 gallons	Rating Cat O
Draft: 1.85 m 6.06 ft		

AMENITIES

Air conditioning
Heating
3x Water Heaters

Stabilizers
Flopper Stoppers
55" 4K TV with Movie hard drive

Complete Music System
2x Fridge | 2x Freezers
Electric BBQ

TENDERS + TOYS

TENDER 1

AB Marine 16
4.9 m | 16 ft
70 Hp | 35 knots
Alloy Hull | Inflatable
10 POBs
AIS | GPS | Chart Plotter | Depth
Sounder | VHF
Anchor | Chain | Rope

TENDER 1

AB Marine 9.5
2.9 m | 9.6 ft
15 Hp | 15 knots
Alloy Hull | Inflatable
Retractable landing wheels
Anchor | Chain | Rope
5 POBs

TOYS

Dive Compressor | 4x Alloy Tanks
2x Kayaks with Seats
Paddle/Surf Boards
Snorkelling | Spearfishing Gear
Fishing Gear
Photography Gear
Underwater Scooter





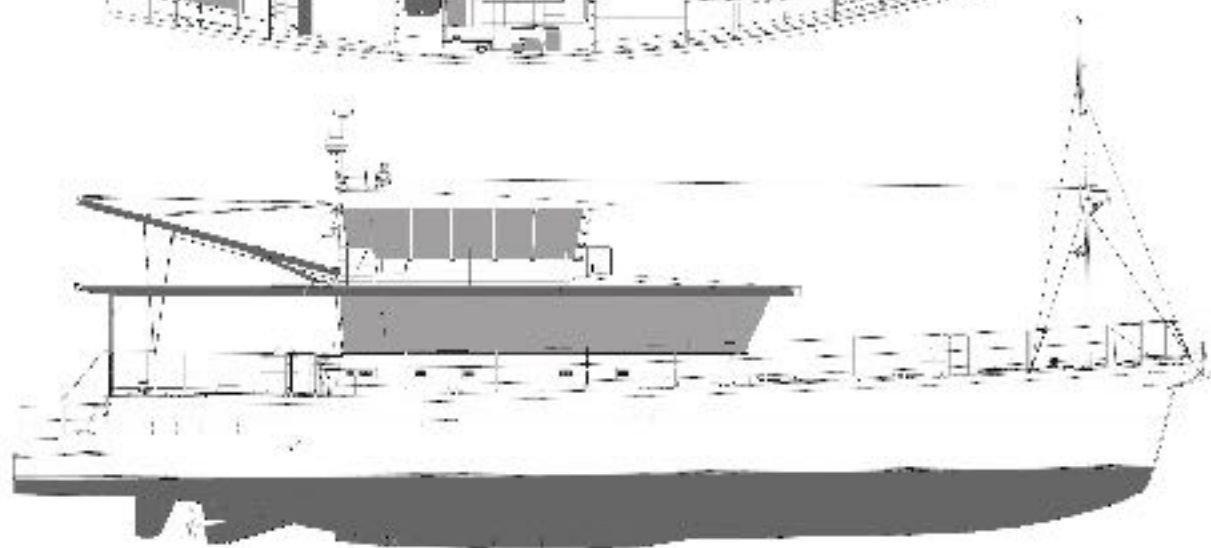
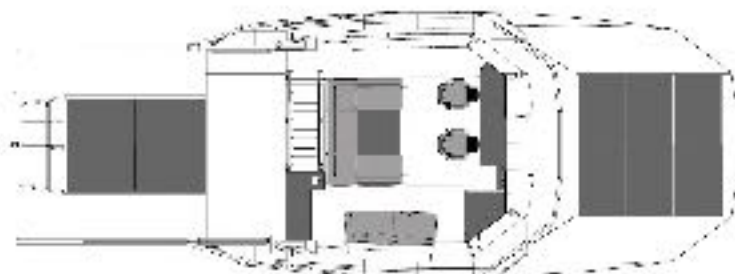



Join us for your next adventure...



